

Index No. 17-5107

CERTIFICATE OF LOCATION OF GOVERNMENT CORNER

NORTHEAST Corner of Section 35, Township 108, Range 43, 5TH P.M.

STATE OF MINNESOTA, County of MURRAY

At the corner location shown on the sketch:

On 03-31-2017 found a 3/8" IRON WITH SEAL #12967.

left monument as found, lowered monument, removed monument (explain)

On _____ placed a _____

SKETCH OF REFERENCE TIES

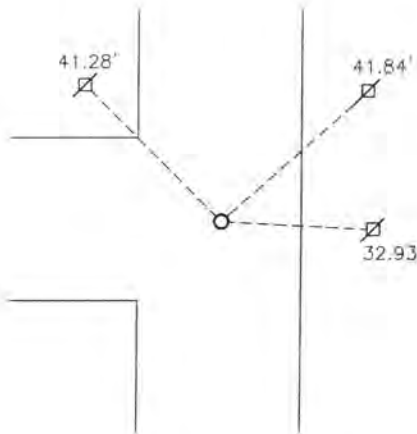

Minnesota State Plane Coordinate
System Murray County Datum
NAD83 (1996)
N: 200690.344
E: 448287.399

Nail and bottle cap in utility pole NW 41.28'
Nail and bottle cap in utility pole NE 41.84'
Nail and bottle cap in guy pole ESE 32.93'

Statement of evidence relative to this corner location is on back of page.

I hereby certify that this document and the data contained herein was prepared by me or under my direct supervision.



SIGNATURE 2/14/18
DATE

Registration No. 43844

- Land Surveyor, Professional Engineer
 County Surveyor, County Engineer

STATE OF MINNESOTA, } ss.
COUNTY OF MURRAY, }

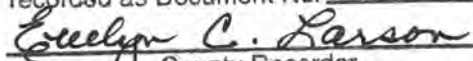
I hereby certify that the within Instrument was filed in this office for record on the 26TH day of MARCH A.D. 20 18 at 9:00 o'clock A. M. and was duly recorded as Document No. _____

County Recorder

Statement of Evidence

In 1866, J.W. Bishop did the original subdivision of the township.

On August 24, 1901, (No name) County Surveyor, found a stone at the corner.

On April 8, 1980, Gary Martin found a stone at the corner. He set a 3/8" iron with seal #12967 over the stone.

On March 31, 2017, Bueltel-Moseng Land Surveying found a 3/8" iron with seal #12967 at the corner.